



City of Westminster

Licensing Sub-Committee Report

Item No:

Licensing Ref No:

15/04057/LIPN

Date:

20 August 2015

Classification:

For General Release

Title of Report:

**Raging Ball Snooker and Sports Club
(Basement)
159-163 Edgware Road
London
W2 2HR**

Report of:

Director of Public Protection and Licensing

Policy context:

**City of Westminster Statement of Licensing
Policy**

Financial summary:

None

Report Author:

**Mr Ola Owojori
Senior Licensing Officer**

Contact Details:

**Telephone: 020 7641 7830
E-mail: oowojori@westminster.gov.uk**

APPLICATION DETAILS

Application Type:	A new premises licence application under the Licensing Act 2003.		
Applicant:	Future Leisure Limited	Date Application Received:	28 May 2015
Premises Name and Address:	Raging Ball Snooker and Sports Club (Basement) 159-163 Edgware Road London W2 2HR		
Ward Name:	Hyde Park	Stress Area:	Edgware Road
Description of Premises:	The premises are to be operated as a snooker club in the basement.		
Preliminary Note	The hours sought for licensable activities have been reduced following representations from the Police and Environmental Health. The hours stated below are the revised hours.		
<i>Note: Where the committee is minded to grant the licence it will be granted subject to the mandatory conditions and conditions consistent with the operating schedule modified to such extent as the authority considers appropriate for the promotion of the licensing objectives detailed in Appendix D to this report.</i>			
Proposed Licensable Activities, Proposed Hours:			
Indoor Sporting Event			
	Sunday to Thursday:	09:00 to 00:00	
	Friday to Saturday:	09:00 to 01:00	
Playing of Recorded Music			
	Sunday to Thursday:	09:00 to 00:00	
	Friday to Saturday:	09:00 to 01:00	
Late Night Refreshment			
	Sunday to Thursday:	23:00 to 00:00	
	Friday to Saturday:	23:00 to 01:00	
Sale by Retail of Alcohol (On the Premises)			
	Monday to Thursday:	10:00 to 00:00	
	Friday to Saturday:	10:00 to 01:00	
	Sunday:	12:00 to 00:00	
Non-standard Timings: On the day when British Summer commences, and on that day only, licensable activities will be extended by one hour.			
New Years Eve - From the end of permitted hours on New Years Eve to the start of permitted hours on New Years Day.			
Opening Hours			
	Monday to Sunday:	00:00 to 00:00	

	Relevant representations and policies applicable:	References / Notes
1A	<p>An adverse representation has been made against the application by the Environmental Health stating that the proposals will have the likely effect of causing an increase in public nuisance and may impact upon public safety in the Edgware Road Stress Area. Subsequently, they have proposed conditions most of which have been agreed by the applicant should the Committee be minded to grant.</p>	<p>Environmental Health Service Representation</p>
1B	<p>An adverse representation has been made against the application by the Police stating that it is their belief that the application if granted will undermine the licensing objectives and cause further policing problem in the Edgware Road stress area. Subsequently, they have proposed conditions most of which have been agreed by the applicant should the Committee be minded to grant.</p>	<p>Metropolitan Police Service representation</p>
1C	<p>Adverse representations have been made against the application by four local residents stating that the application if granted will lead to an increase in public nuisance and may exacerbate noise in the area.</p>	<p>Local Residents representations</p>
1D	<p>The following policies within the City Of Westminster Statement of Licensing Policy apply:</p> <p>Policy STR1 applies:</p> <p>(i) It is the Licensing Authority's policy to refuse applications in the Stress Areas for: pubs and bars; fast food premises and premises offering facilities for music and dancing other than applications to vary hours within the Core Hours under Policy HRS1</p> <p>(ii) Applications for other licensable activities in the Stress Areas will be subject to other policies and must demonstrate that they will not add to cumulative impact in the Stress Areas.</p> <p>Policy HRS1 applies:</p> <p>(i) Applications for hours within the core hours set out in this policy will generally be granted, subject to not being contrary to other policies in the Statement of Licensing Policy.</p> <p>(ii) Applications for hours outside the core hours in this policy will be considered on their merits, subject to other relevant policies and with particular regard to criteria set out in the policy:</p> <p>Policy PB2 applies:</p> <p>It is the Licensing Authority's policy to refuse applications in the Stress Areas other than applications to vary hours within the Core Hours under Policy HRS1.</p>	<p>Policies applicable</p>
1E	<p>The Licensing Sub-committee may refuse, grant in full or grant in part this proposal, having taken into account the representations received and Westminster's Statement of Licensing Policy. The decision taken should promote the licensing objectives of:</p> <ul style="list-style-type: none"> • prevention of public nuisance, • prevention of crime & disorder, • public safety and • protection of children from harm. 	<p>Summary</p>

1F	Where the committee is minded to grant the licence it will be granted subject to the mandatory conditions and conditions consistent with the operating schedule modified to such extent as the authority considers appropriate for the promotion of the licensing objectives. Proposed conditions are set out detailed in Appendix B to this report.	
Current Licensing Position	The premises were previously licensed as a supermarket for sale of alcohol for consumption off the premises until 14 November 2011 when the licence was surrendered. Please refer to Appendix A	
Residential Density:	565 units within a 75m radius of the premises are residential or proposed residential, refer to Appendix C .	
Planning Position:	Planning permission for the use of basement and part ground floor level as members only snooker club is pending consideration.	
List of Appendices:	A – Premises Licence History B - Proposed Conditions C – Residential Map and list of premises in the vicinity	

Background Documents – Local Government (Access to Information) Act 1972

- Licensing Act 2003
- City of Westminster Statement of Licensing Policy (7th January 2011)
- Amended Guidance issued under section 182 of the Licensing Act 2003 (March 2015)
- Application form
- Plans
- Representations received
- Photos

Licence & Appeal History

Application	Details of Application	Date Determined	Decision
Conversion Application	Application to convert existing Justices Off licence	28/8/05	Granted under delegated authority
Variation	Application to change the layout of the premises.	18/6/08	Granted by Licensing Authority Licence surrendered 14/11/11

There is no licence or appeal history for the premises by this applicant.

CONDITIONS CONSISTENT WITH THE OPERATING SCHEDULE AND CONDITIONS PROPOSED BY A PARTY TO THE HEARING

When determining an application for a new premises licence under the provisions of the Licensing Act 2003, the licensing authority must, unless it decides to reject the application, grant the licence subject to the conditions which are indicated as mandatory in this schedule.

At a hearing the licensing authority may, in addition, and having regard to any representations received, grant the licence subject to such conditions which are consistent with the operating schedule submitted by the applicant as part of their application, or alter or omit these conditions, or add any new condition to such extent as the licensing authority considers necessary for the promotion of the licensing objectives.

This schedule lists those conditions which are consistent with the operating schedule, or proposed as necessary for the promotion of the licensing objectives by a responsible authority or an interested party as indicated. These conditions have not been submitted by the licensing service but reflect the positions of the applicant, responsible authority or interested party and have not necessarily been agreed

Mandatory Conditions

1. No supply of alcohol may be made at a time when there is no designated premises supervisor in respect of this licence.
2. No supply of alcohol may be made at a time when the designated premises supervisor does not hold a personal licence or the personal licence is suspended.
3. Every supply of alcohol under this licence must be made or authorised by a person who holds a personal licence.
4.
 - (1) The responsible person must ensure that staff on relevant premises do not carry out, arrange or participate in any irresponsible promotions in relation to the premises.
 - (2) In this paragraph, an irresponsible promotion means any one or more of the following activities, or substantially similar activities, carried on for the purpose of encouraging the sale or supply of alcohol for consumption on the premises—
 - (a) games or other activities which require or encourage, or are designed to require or encourage, individuals to;
 - (i) drink a quantity of alcohol within a time limit (other than to drink alcohol sold or supplied on the premises before the cessation of the period in which the responsible person is authorised to sell or supply alcohol), or
 - (ii) drink as much alcohol as possible (whether within a time limit or otherwise);
 - (b) provision of unlimited or unspecified quantities of alcohol free or for a fixed or discounted fee to the public or to a group defined by a particular characteristic in a manner which carries a significant risk of undermining a licensing objective;
 - (c) provision of free or discounted alcohol or any other thing as a prize to encourage or reward the purchase and consumption of alcohol over a period of 24 hours or less in a manner which carries a significant risk of undermining a licensing objective;
 - (d) selling or supplying alcohol in association with promotional posters or flyers on, or in the vicinity of, the premises which can reasonably be considered to condone,

encourage or glamorise anti-social behaviour or to refer to the effects of drunkenness in any favourable manner;

- (e) dispensing alcohol directly by one person into the mouth of another (other than where that other person is unable to drink without assistance by reason of a disability).
5. The responsible person must ensure that free potable water is provided on request to customers where it is reasonably available.
6. (1) The premises licence holder or club premises certificate holder must ensure that an age verification policy is adopted in respect of the premises in relation to the sale or supply of alcohol.
- (2) The designated premises supervisor in relation to the premises licence must ensure that the supply of alcohol at the premises is carried on in accordance with the age verification policy.
- (3) The policy must require individuals who appear to the responsible person to be under 18 years of age (or such older age as may be specified in the policy) to produce on request, before being served alcohol, identification bearing their photograph, date of birth and either—
- (a) a holographic mark, or
 - (b) an ultraviolet feature.
7. The responsible person must ensure that—
- (a) where any of the following alcoholic drinks is sold or supplied for consumption on the premises (other than alcoholic drinks sold or supplied having been made up in advance ready for sale or supply in a securely closed container) it is available to customers in the following measures—
 - (i) beer or cider: ½ pint;
 - (ii) gin, rum, vodka or whisky: 25 ml or 35 ml; and
 - (iii) still wine in a glass: 125 ml;
 - (b) these measures are displayed in a menu, price list or other printed material which is available to customers on the premises; and
 - (c) where a customer does not in relation to a sale of alcohol specify the quantity of alcohol to be sold, the customer is made aware that these measures are available.

A responsible person in relation to a licensed premises means the holder of the premise licence in respect of the premises, the designated premises supervisor (if any) or any individual aged 18 or over who is authorised by either the licence holder or designated premises supervisor. For premises with a club premises certificate, any member or officer of the club present on the premises in a capacity that which enables him to prevent the supply of alcohol.

8(i) A relevant person shall ensure that no alcohol is sold or supplied for consumption on or off the premises for a price which is less than the permitted price.

8(ii) For the purposes of the condition set out in paragraph 8(i) above -

- (a) "duty" is to be construed in accordance with the Alcoholic Liquor Duties Act 1979;
- (b) "permitted price" is the price found by applying the formula -

$$P = D + (D \times V)$$

Where -

- (i) P is the permitted price,
- (ii) D is the amount of duty chargeable in relation to the alcohol as if the duty were charged on the date of the sale or supply of the alcohol, and
- (iii) V is the rate of value added tax chargeable in relation to the alcohol as if the value added tax were charged on the date of the sale or supply of the alcohol;

(c) "relevant person" means, in relation to premises in respect of which there is in force a premises licence -

- (i) the holder of the premises licence,
- (ii) the designated premises supervisor (if any) in respect of such a licence, or
- (iii) the personal licence holder who makes or authorises a supply of alcohol under such a licence;

(d) "relevant person" means, in relation to premises in respect of which there is in force a club premises certificate, any member or officer of the club present on the premises in a capacity which enables the member or officer to prevent the supply in question; and

(e) "value added tax" means value added tax charged in accordance with the Value Added Tax Act 1994.

8(iii). Where the permitted price given by Paragraph 8(ii)(b) above would (apart from this paragraph) not be a whole number of pennies, the price given by that sub-paragraph shall be taken to be the price actually given by that sub-paragraph rounded up to the nearest penny.

8(iv). (1) Sub-paragraph 8(iv)(2) below applies where the permitted price given by Paragraph 8(ii)(b) above on a day ("the first day") would be different from the permitted price on the next day ("the second day") as a result of a change to the rate of duty or value added tax.

(2) The permitted price which would apply on the first day applies to sales or supplies of alcohol which take place before the expiry of the period of 14 days beginning on the second day.

9. All persons guarding premises against unauthorised access or occupation or against outbreaks of disorder or against damage (door supervisors) must be licensed by the Security Industry Authority.

Conditions proposed by the Environmental Health and agreed by the applicant (except 14, 39 and 40)

10. A noise limiter must be fitted to the musical amplification system set at a level determined by and to the satisfaction of an authorised officer of the Environmental Health Service, Premises Management so as to ensure that no noise nuisance is caused to local residents or businesses. The operational panel of the noise limiter shall then be secured by key or password to the satisfaction of officers from the Environmental Health Service and access shall only be by persons authorised by the Premises Licence holder. The limiter shall not be altered without prior agreement with the Environmental Health Service. No alteration or modification to any existing sound system(s) should be effected without prior knowledge of an authorised Officer of the Environmental Health Service. No additional sound generating equipment shall be used on the premises without being routed through the sound limiter device.

11. No noise shall emanate from the premises nor vibration be transmitted through the structure of the premises which gives rise to a nuisance.

12. Loudspeakers shall not be located in the ground floor entrance lobby or outside the premises building.
13. All external doors shall be kept closed after 21:00 hours, or at any time when regulated entertainment takes place, except for the immediate access and egress of persons.
14. Notices shall be prominently displayed at all exits requesting patrons to respect the needs of local residents and businesses and leave the area quietly.
15. Notices shall be prominently displayed at any area used for smoking requesting patrons to respect the needs of local residents and use the area quietly.
16. Patrons permitted to temporarily leave and then re-enter the premises, e.g. to smoke, shall be limited to 15 persons at any one time.
17. Patrons permitted to temporarily leave and then re-enter the premises, e.g. to smoke, shall not be permitted to take drinks or glass containers with them.
18. A direct telephone number for the manager at the premises shall be publicly available at all times the premises is open. This telephone number is to be made available to residents and businesses in the vicinity.
19. No waste or recyclable materials, including bottles, shall be moved, removed from or placed in outside areas between 23.00 hours and 08.00 hours on the following day.
20. No deliveries to the premises shall take place between 23.00 and 08.00 on the following day.
21. There shall be no sales of hot food or hot drink for consumption off the premises
22. The number of persons permitted in the premises at any one time (excluding staff) shall not exceed (X) persons.
23. Substantial food and non-intoxicating beverages, including drinking water, shall be available in all parts of the premises where alcohol is sold or supplied for consumption on the premises.
24. A Challenge 25 proof of age scheme shall be operated at the premises where the only acceptable forms of identification are recognised photographic identification cards, such as a driving licence, passport or proof of age card with the PASS Hologram.
25. The Licence will have no effect until the Licensing Authority are satisfied that the premises is constructed or altered in accordance with the appropriate provisions of the District Surveyor's Association – Technical Standards for Places of Entertainment and the reasonable requirements of Westminster Environmental Health Consultation Team, at which time this condition will be removed from the Licence.
26. Before the premises open to the public, the plans as deposited will be checked by the Environmental Health Consultation Team to ensure they are an accurate reflection of the premises constructed. Where the premises layout has changed during the course of construction a variation application may be required
27. All external emergency exit doors shall be fitted with sensor alarms and visible indicators to alert staff when the doors have been opened.
28. The approved arrangements at the premises, including means of escape provisions, emergency warning equipment, the electrical installation and mechanical equipment, shall at all material times be maintained in good condition and full working order.

29. The means of escape provided for the premises shall be maintained unobstructed, free of trip hazards, be immediately available and clearly identified in accordance with the plans provided.
30. All emergency exit doors shall be available at all material times without the use of a key, code, card or similar means.
31. All emergency doors shall be maintained effectively self-closing and not held open other than by an approved device.
32. The edges of the treads of steps and stairways shall be maintained so as to be conspicuous.
33. Curtains and hangings shall be arranged so as not to obstruct emergency safety signs or emergency equipment.
34. All fabrics, curtains, drapes and similar features including materials used in finishing and furnishing shall be either non-combustible or be durably or inherently flame-retarded fabric. Any fabrics used in escape routes (other than foyers), entertainment areas or function rooms, shall be non-combustible.
35. Appropriate safety devices (such as 30mA Residual Current Devices at Source) must be used for electrical apparatus, particularly for any electrical equipment exposed to adverse conditions or in association with hand held devices (e.g. microphones). The competent person must make a certificate of inspection of the electrical installation available for inspection.
36. Any special effects or mechanical installations shall be arranged and stored so as to minimise any risk to the safety of those using the premises. The following special effects will only be used on 10 days prior notice being given to the Licensing Authority where consent has not previously been given.
 - dry ice and cryogenic fog
 - smoke machines and fog generators
 - pyrotechnics including fireworks
 - firearms
 - lasers
 - explosives and highly flammable substances.
 - real flame.
 - strobe lighting.
37. No person shall give at the premises any exhibition, demonstration or performance of hypnotism, mesmerism or any similar act or process which produces or is intended to produce in any other person any form of induced sleep or trance in which susceptibility of the mind of that person to suggestion or direction is increased or intended to be increased.

NOTE: (1) This rule does not apply to exhibitions given under the provisions of Section 2(1A) and 5 of the Hypnotism Act 1952.
38. There is to be no external advertisement on the street of bar facilities.
39. The licensable activities authorised by this licence and provided at the premises shall be ancillary to the main function of the premises as a members' snooker and sports club.
40. Access to the premises may only be by members of a private club and their bona fide guests (not exceeding 4 guests per member). No person shall be admitted to membership of the private club or be entitled to take advantage of any of the privileges of membership without an interval of at least 48 hours between their nomination or application for membership and their admission.
41. A list of the names and addresses of members of the Club shall be kept on the premises at all times together with a book showing the names and dates of attendance of any guests introduced

by members. Both the list and the book shall be produced on demand for inspection by the police or an authorised officer of the Council.

Proposed by the Police and agreed by the applicant (Except 44 and 45)

42. The premises shall install and maintain a comprehensive CCTV system as per the minimum requirements of the Westminster Police Licensing Team. All entry and exit points will be covered enabling frontal identification of every person entering in any light condition. The CCTV system shall continually record whilst the premises is open for licensable activities and during all times when customers remain on the premises. All recordings shall be stored for a minimum period of 31 days with date and time stamping. Viewing of recordings shall be made available immediately upon the request of Police or authorised officer throughout the preceding 31 day period.
43. A staff member from the premises who is conversant with the operation of the CCTV system shall be on the premises at all times when the premises is open. This staff member must be able to provide a Police or authorised council officer copies of recent CCTV images or data with the absolute minimum of delay when requested.
44. A minimum of (No. TBC) SIA licensed door supervisors shall be on duty at the premises at all times whilst it is open for business.
45. At least (No. TBC) SIA licensed door supervisors shall be on duty at the entrance of the premises at all times whilst it is open for business.
46. There shall be no sales of alcohol for consumption off the premises.
47. Patrons permitted to temporarily leave and then re-enter the premises, e.g. to smoke, shall be limited to (no. TBC) persons at any one time.
48. The licence holder shall ensure that any queue to enter the premises which forms outside the premises is orderly and supervised by door staff so as to ensure that there is no public nuisance or obstruction to the public highway.
49. Substantial food and non-intoxicating beverages, including drinking water, shall be available in all parts of the premises where alcohol is sold or supplied for consumption on the premises.
50. There shall be no striptease or nudity, and all persons shall be decently attired at all times, except when the premises are operating under the authority of a Sexual Entertainment Venue licence.
51. No advertisements of any kind (including placard, poster, sticker, flyer, picture, letter, sign or other mark) that advertises or promotes the establishment, its premises, or any of its events, facilities, goods or services shall be inscribed or affixed upon the surface of the highway, or upon any building, structure, works, street furniture, tree, or any other property, or be distributed
52. A Challenge 25 proof of age scheme shall be operated at the premises where the only acceptable forms of identification are recognised photographic identification cards, such as a driving licence, passport or proof of age card with the PASS Hologram.
53. An incident log shall be kept at the premises, and made available on request to an authorised officer of the City Council or the Police, which will record the following:
 - (a) all crimes reported to the venue
 - (b) all ejections of patrons
 - (c) any complaints received concerning crime and disorder
 - (d) any incidents of disorder
 - (e) all seizures of drugs or offensive weapons
 - (f) any faults in the CCTV system or searching equipment or scanning equipment

- (g) any refusal of the sale of alcohol
- (h) any visit by a relevant authority or emergency service.

- 54. Patrons permitted to temporarily leave and then re-enter the premises, eg to smoke, shall not be permitted to take drinks or glass containers with them.
- 55. The licence holder shall enter into an agreement with a hackney carriage and/or private carriage firm to provide transport for customers, with contact numbers made readily available to customers who will be encouraged to use such services.
- 56. A legible register of the full names and address of the members of the club shall be kept on the premises at all times, together with a legible record showing the full names and dates of attendance of any guests introduced by members. Both the list and the book shall be produced on demand for inspection by the Police or an authorised officer of the Council.

Condition proposed by the applicant

- 57. The front door to the premises will be locked at all times with access to the premises only permitted to members and their guests who will be allowed access via an intercom system.
(Alternative to conditions 44 and 45)
- 58. Children under the age of 18 is not permitted in the premises after 21:00 hours



Raging Ball

APPENDIX C

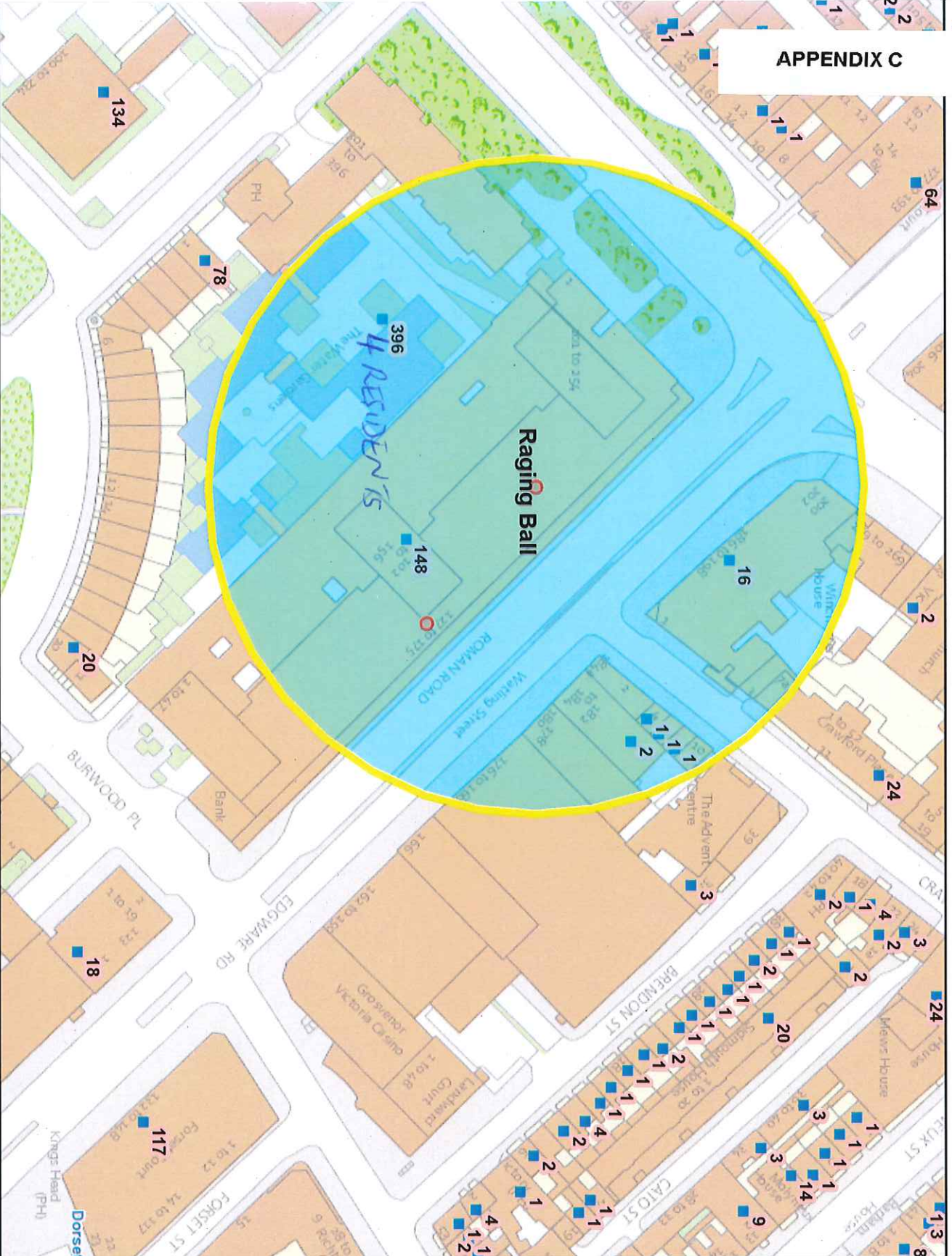

10 Meters

This product includes mapping data licensed from Ordnance Survey with the permission of the Controller of Her Majesty's Stationery Office. © Crown copyright and/or database right 2013. All rights reserved. Licence number: 1A 100010507

Residential / Proposed Residential	565
Under Construction	0
Other Uses	Not known
Proportion Residential of all Uses	Not known
Data Source: Uniform Database	
Date: 02/07/2015	

Background Documents

2

Westminster City Council

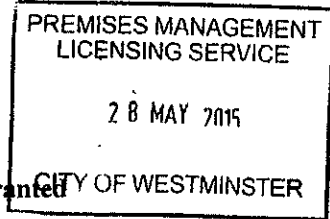

Application for a premises licence to be granted under the Licensing Act 2003

PLEASE READ THE FOLLOWING INSTRUCTIONS FIRST

Before completing this form please read the guidance notes at the end of the form. If you are completing this form by hand please write legibly in block capitals. In all cases ensure that your answers are inside the boxes and written in black ink. Use additional sheets if necessary.

You may wish to keep a copy of the completed form for your records.

I/We Future Leisure Limited
(Insert name(s) of applicant)

apply for a premises licence under section 17 of the Licensing Act 2003 for the premises described in Part 1 below (the premises) and I/we are making this application to you as the relevant licensing authority in accordance with section 12 of the Licensing Act 2003

Part 1 – Premises Details

Postal address of premises or, if none, ordnance survey map reference or description Raging Ball Sports Club Basement 159-163 Edgware Road			
Post town	London	Postcode	W2 2HR

Telephone number at premises (if any)	
Non-domestic rateable value of premises	£ Not yet rated

Part 2 - Applicant Details

Please state whether you are applying for a premises licence as

Please tick as appropriate

- a) an individual or individuals * please complete section (A)
- b) a person other than an individual *
 - i. as a limited company please complete section (B)
 - ii. as a partnership please complete section (B)
 - iii. as an unincorporated association or please complete section (B)
 - iv. other (for example a statutory corporation) please complete section (B)

- c) a recognised club please complete section (B)
- d) a charity please complete section (B)
- e) the proprietor of an educational establishment please complete section (B)
- f) a health service body please complete section (B)
- g) a person who is registered under Part 2 of the Care Standards Act 2000 (c14) in respect of an independent hospital in Wales please complete section (B)
- ga) a person who is registered under Chapter 2 of Part 1 of the Health and Social Care Act 2008 (within the meaning of that Part) in an independent hospital in England please complete section (B)
- h) the chief officer of police of a police force in England and Wales please complete section (B)

* If you are applying as a person described in (a) or (b) please confirm:

Please tick yes

I am carrying on or proposing to carry on a business which involves the use of the premises for licensable activities; or

I am making the application pursuant to a statutory function or
 a function discharged by virtue of Her Majesty's prerogative

(A) INDIVIDUAL APPLICANTS (fill in as applicable)

Mr <input type="checkbox"/>	Mrs <input type="checkbox"/>	Miss <input type="checkbox"/>	Ms <input type="checkbox"/>	Other Title (for example, Rev)	
Surname			First names		
I am 18 years old or over				<input type="checkbox"/> Please tick yes	
Current postal address if different from premises address					
Post town				Postcode	
Daytime contact telephone number					
E-mail address (optional)					

SECOND INDIVIDUAL APPLICANT (if applicable)

Mr <input type="checkbox"/>	Mrs <input type="checkbox"/>	Miss <input type="checkbox"/>	Ms <input type="checkbox"/>	Other Title (for example, Rev)	
Surname			First names		
I am 18 years old or over					<input type="checkbox"/> Please tick yes
Current postal address if different from premises address					
Post town		Postcode			
Daytime contact telephone number					
E-mail address (optional)					

(B) OTHER APPLICANTS

Please provide name and registered address of applicant in full. Where appropriate please give any registered number. In the case of a partnership or other joint venture (other than a body corporate), please give the name and address of each party concerned.

Name Future Leisure Limited
Address Hamilton House 25 High Street Rickmansworth Hertfordshire WD3 1ET
Registered number (where applicable) 05316966
Description of applicant (for example, partnership, company, unincorporated association etc.) Limited Company
Telephone number (if any)
E-mail address (optional)

Part 3 Operating Schedule

When do you want the premises licence to start?

DD	MM	YYYY
A	S	A P

If you wish the licence to be valid only for a limited period, when do you want it to end?

DD	MM	YYYY

Please give a general description of the premises (please read guidance note 1)
The entrance on Edgware Road leads to a basement sports club which will provide pool and snooker and alcohol which after specific times will only be to members and guests . Late night refreshment will also be provided. There will be no entertainment other than background music.

If 5,000 or more people are expected to attend the premises at any one time, please state the number expected to attend.

N/A

What licensable activities do you intend to carry on from the premises?

(Please see sections 1 and 14 of the Licensing Act 2003 and Schedules 1 and 2 to the Licensing Act 2003)

Provision of regulated entertainment

Please tick any that apply

- a) plays (if ticking yes, fill in box A)
- b) films (if ticking yes, fill in box B)
- c) indoor sporting events (if ticking yes, fill in box C)
- d) boxing or wrestling entertainment (if ticking yes, fill in box D)
- e) live music (if ticking yes, fill in box E)
- f) recorded music (if ticking yes, fill in box F)
- g) performances of dance (if ticking yes, fill in box G)
- h) anything of a similar description to that falling within (e), (f) or (g) (if ticking yes, fill in box H)

Provision of late night refreshment (if ticking yes, fill in box I)

Supply of alcohol (if ticking yes, fill in box J)

In all cases complete boxes K, L and M

A

Plays Standard days and timings (please read guidance note 6)			Will the performance of a play take place indoors or outdoors or both – please tick (please read guidance note 2)	Indoors	<input type="checkbox"/>
				Outdoors	<input type="checkbox"/>
				Both	<input type="checkbox"/>
Day	Start	Finish	Please give further details here (please read guidance note 3)		
Mon					
Tue					
Wed					
			State any seasonal variations for performing plays (please read guidance note 4)		
Thur					
			Non standard timings. Where you intend to use the premises for the performance of plays at different times to those listed in the column on the left, please list (please read guidance note 5)		
Fri					
Sat					
Sun					

B

Films Standard days and timings (please read guidance note 6)			Will the exhibition of films take place indoors or outdoors or both – please tick (please read guidance note 2)	Indoors	<input type="checkbox"/>
				Outdoors	<input type="checkbox"/>
				Both	<input type="checkbox"/>
Day	Start	Finish	Please give further details here (please read guidance note 3)		
Mon					
Tue					
Wed					
			State any seasonal variations for the exhibition of films (please read guidance note 4)		
Thur					

			Non standard timings. Where you intend to use the premises for the exhibition of films at different times to those listed in the column on the left, please list (please read guidance note 5)
Fri			
Sat			
Sun			

C

Indoor sporting events Standard days and timings (please read guidance note 6)			Please give further details (please read guidance note 3) To include snooker and pool competitions.	
Day	Start	Finish	State any seasonal variations for indoor sporting events (please read guidance note 4)	
Mon	00.00	24.00		
	24	Hours		
Tue	00.00	24.00		
	24	Hours		
Wed	00.00	24.00		
	24	Hours		
Thur	00.00	24.00		Non standard timings. Where you intend to use the premises for indoor sporting events at different times to those listed in the column on the left, please list (please read guidance note 5)
	24	Hours		
Fri	00.00	24.00		
	24	Hours		
Sat	00.00	24.00		
	24	Hours		
Sun	00.00	24.00		
	24	Hours		

D

Boxing or wrestling entertainments Standard days and timings (please read guidance note 6)	Will the boxing or wrestling entertainment take place indoors or outdoors or both – please tick (please read guidance note 2)	Indoors	<input type="checkbox"/>
		Outdoors	<input type="checkbox"/>

Day	Start	Finish		Both	<input type="checkbox"/>
Mon			Please give further details here (please read guidance note 3)		
Tue					
Wed			State any seasonal variations for boxing or wrestling entertainment (please read guidance note 4)		
Thur					
Fri			Non standard timings. Where you intend to use the premises for boxing or wrestling entertainment at different times to those listed in the column on the left, please list (please read guidance note 5)		
Sat					
Sun					

E

Live music Standard days and timings (please read guidance note 6).			Will the performance of live music take place <u>indoors or outdoors or both – please tick</u> (please read guidance note 2)	Indoors	<input type="checkbox"/>
Day	Start	Finish		Outdoors	<input type="checkbox"/>
Mon				Both	<input type="checkbox"/>
Tue					
Wed			State any seasonal variations for the performance of live music (please read guidance note 4)		
Thur					
Fri			Non standard timings. Where you intend to use the premises for the performance of live music at different times to those listed in the column on the left, please list (please read guidance note 5)		
Sat					

Sun			

F

Recorded music Standard days and timings (please read guidance note 6)			Will the playing of recorded music take place indoors or outdoors or both – please tick (please read guidance note 2)	Indoors	<input checked="" type="checkbox"/>						
				Outdoors	<input type="checkbox"/>						
				Both	<input type="checkbox"/>						
Day	Start	Finish	Please give further details here (please read guidance note 3) Background music only								
Mon	00.00	24.00									
	24	Hours									
Tue	00.00	24.00									
	24	Hours									
Wed	00.00	24.00				State any seasonal variations for the playing of recorded music (please read guidance note 4)					
	24	Hours									
Thur	00.00	24.00									
	24	Hours									
Fri	00.00	24.00							Non standard timings. Where you intend to use the premises for the playing of recorded music at different times to those listed in the column on the left, please list (please read guidance note 5)		
	24	Hours									
Sat	00.00	24.00									
	24	Hours									
Sun	00.00	24.00									
	24	Hours									

G

Performances of dance Standard days and timings (please read guidance note 6)			Will the performance of dance take place indoors or outdoors or both – please tick (please read guidance note 2)	Indoors	<input type="checkbox"/>
				Outdoors	<input type="checkbox"/>
				Both	<input type="checkbox"/>
Day	Start	Finish	Please give further details here (please read guidance note 3)		
Mon					
Tue					

Wed			State any seasonal variations for the performance of dance (please read guidance note 4)
Thur			
Fri			Non standard timings. Where you intend to use the premises for the performance of dance at different times to those listed in the column on the left, please list (please read guidance note 5)
Sat			
Sun			

H

Anything of a similar description to that falling within (e), (f) or (g) Standard days and timings (please read guidance note 6)			Please give a description of the type of entertainment you will be providing		
Day	Start	Finish	Will this entertainment take place indoors or outdoors or both – please tick (please read guidance note 2)	Indoors	<input type="checkbox"/>
Mon				Outdoors	<input type="checkbox"/>
				Both	<input type="checkbox"/>
Tue			Please give further details here (please read guidance note 3)		
Wed					
Thur			State any seasonal variations for entertainment of a similar description to that falling within (e), (f) or (g) (please read guidance note 4)		
Fri					
Sat			Non standard timings. Where you intend to use the premises for the entertainment of a similar description to that falling within (e), (f) or (g) at different times to those listed in the column on the left, please list (please read guidance note 5)		

Sun			

I

Late night refreshment Standard days and timings (please read guidance note 6)			Will the provision of late night refreshment take place indoors or outdoors or both – please tick (please read guidance note 2)	Indoors	<input checked="" type="checkbox"/>
Day	Start	Finish		Outdoors	<input type="checkbox"/>
Mon	23.00	05.00	<u>Please give further details here</u> (please read guidance note 3) Provision of hot food and drinks	Both	<input type="checkbox"/>
Tue	23.00	05.00			
Wed	23.00	05.00	<u>State any seasonal variations for the provision of late night refreshment</u> (please read guidance note 4)		
Thur	23.00	05.00			
Fri	23.00	05.00	<u>Non standard timings. Where you intend to use the premises for the provision of late night refreshment at different times, to those listed in the column on the left, please list</u> (please read guidance note 5)		
Sat	23.00	05.00			
Sun	23.00	05.00			

J

Supply of alcohol Standard days and timings (please read guidance note 6)			Will the supply of alcohol be for consumption – please tick (please read guidance note 7)	On the premises	<input type="checkbox"/>
				Off the premises	<input type="checkbox"/>
				Both	<input checked="" type="checkbox"/>
Day	Start	Finish	State any seasonal variations for the supply of alcohol (please read guidance note 4)		
Mon	08.00	03.00			
Tue	08.00	03.00			
Wed	08.00	03.00			
Thur	08.00	03.00			
			Non standard timings. Where you intend to use the premises for the supply of alcohol at different times to those listed in the column on the left, please list (please read guidance note 5) On the day when British Summer Time commences, and on that day only, licensable activities will be extended by one hour. New Year's Eve – From the end of permitted hours on New Year's Eve to the start of permitted hours on New Year's Day.		
Fri	08.00	03.00			
Sat	08.00	03.00			
Sun	08.00	03.00			

State the name and details of the individual whom you wish to specify on the licence as designated premises supervisor:

Name Gavin David Tressider	
Address	
Postcode	
Personal licence number (if known)	
Issuing licensing authority (if known)	

K

Please highlight any adult entertainment or services, activities, other entertainment or matters ancillary to the use of the premises that may give rise to concern in respect of children (please read guidance note 8).
Not applicable

L

Hours premises are open to the public Standard days and timings (please read guidance note 6)			State any seasonal variations (please read guidance note 4)
Day	Start	Finish	
Mon	00.00	24.00	<p><u>Non standard timings. Where you intend the premises to be open to the public at different times from those listed in the column on the left, please list</u> (please read guidance note 5)</p>
	24	Hours	
Tue	00.00	24.00	
	24	Hours	
Wed	00.00	24.00	
	24	Hours	
Thur	00.00	24.00	
	24	Hours	
Fri	00.00	24.00	
	24	Hours	
Sat	00.00	24.00	
	24	Hours	
Sun	00.00	24.00	
	24	Hours	

M Describe the steps you intend to take to promote the four licensing objectives:

a) General – all four licensing objectives (b, c, d and e) (please read guidance note 9)

The Premises will operate as a Sports Club offering Pool and /or Snooker and other facilities to which the sale of alcohol will be an ancillary activity.

b) The prevention of crime and disorder

1. The premises shall install and maintain a comprehensive CCTV system as per the minimum requirements of the Westminster Police Licensing Team. All entry and exit points will be covered enabling frontal identification of every person entering in any light condition. The CCTV system shall continually record whilst the premises is open for licensable activities and during all times when customers remain on the premises. All recordings shall be stored for a minimum period of 31 days with date and time stamping. Viewing of recordings shall be made available immediately upon the request of Police or authorised officer throughout the preceding 31 day period.
2. A staff member from the premises who is conversant with the operation of the CCTV system shall be on the premises at all times when the premises is open. This staff member must be able to provide a Police or authorised council officer copies of recent CCTV images or data with the absolute minimum of delay when requested.
3. All sales of alcohol for consumption off the premises shall be in sealed containers only, and shall not be consumed on the premises.
4. A Challenge 21 or Challenge 25 proof of age scheme shall be operated at the premises where the only acceptable forms of identification are recognised photographic identification cards, such as a driving licence, passport or proof of age card with the PASS Hologram.
5. A record shall be kept detailing all refused sales of alcohol. The record should include the date and time of the refused sale and the name of the member of staff who refused the sale. The record shall be available for inspection at the premises by the police or an authorised officer of the City Council at all times whilst the premises is open.
6. After midnight on Friday and Saturday and 23:00 Sunday to Thursday alcohol may only be sold for consumption by members and their bona fide guests (not exceeding 4 guests per member).
7. A list of the names and addresses of members of the Club shall be kept on the premises at all times together with a book showing the names and dates of attendance of any guests introduced by members. Both the list and the book shall be produced on demand for inspection by the police or an authorised officer of the Council.

c) Public safety

See (a), (b) and (d)

d) The prevention of public nuisance

1. Notices shall be prominently displayed at all exits requesting patrons to respect the needs of local residents and businesses and leave the area quietly.

e) The protection of children from harm

See (a), (b) and (d) above

Checklist:

Please tick to indicate agreement

- I have made or enclosed payment of the fee.
- I have enclosed the plan of the premises.
- I have sent copies of this application and the plan to responsible authorities and others where applicable.
- I have enclosed the consent form completed by the individual I wish to be designated premises supervisor, if applicable.
- I understand that I must now advertise my application.
- I understand that if I do not comply with the above requirements my application will be rejected.

IT IS AN OFFENCE, LIABLE ON SUMMARY CONVICTION TO A FINE NOT EXCEEDING LEVEL 5 ON THE STANDARD SCALE, UNDER SECTION 158 OF THE LICENSING ACT 2003, TO MAKE A FALSE STATEMENT IN OR IN CONNECTION WITH THIS APPLICATION.

Part 4 – Signatures (please read guidance note 10)

Signature of applicant or applicant's solicitor or other duly authorised agent (see guidance note 11). **If signing on behalf of the applicant, please state in what capacity.**

Signature	<i>Woods Whur 2014 Limited</i>
Date	27 May 2015
Capacity	Woods Whur 2014 Limited – Solicitors for the applicant

For joint applications, signature of 2nd applicant or 2nd applicant's solicitor or other authorised agent (please read guidance note 12). **If signing on behalf of the applicant, please state in what capacity.**

Signature	
Date	
Capacity	

Contact name (where not previously given) and postal address for correspondence associated with this application (please read guidance note 13) Andrew Woods Woods Whur 2014 Limited Devonshire House 38 York Place			
Post town	Leeds	Postcode	LS1 2ED
Telephone number (if any)	0113 234 3055		
If you would prefer us to correspond with you by e-mail, your e-mail address (optional) andrew@woodswhur.co.uk			

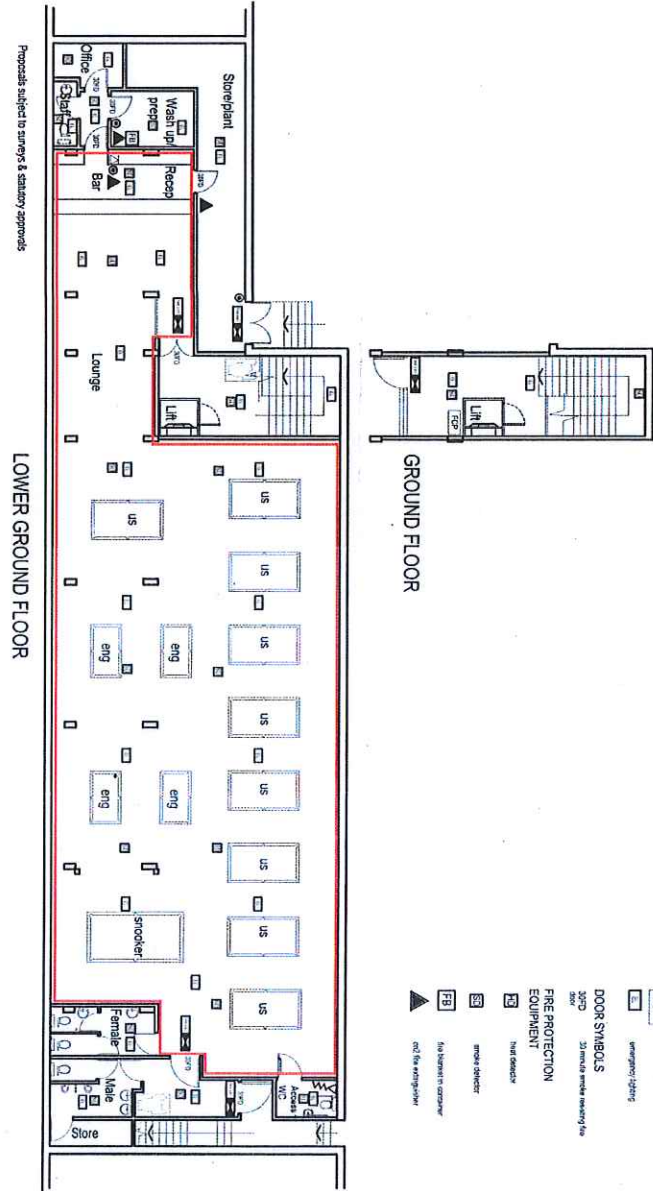

Processes subject to surveys & statutory approvals

- KEY**
- Area to be used for installation and/or consumption of special provisions of required performance and depth of the right-hand side
- The location and type of any fire alarm and any other safety equipment is shown as follows. This may be subject to fire risk assessment and approval of the fire authority. The fire alarm system is shown as follows: fire alarm system to be installed in accordance with BS 5839 part 1:2011 & BS 5839 part 2:2011
- EMERGENCY WARNING EQUIPMENT**
- Standard fire alarm pull point
 - Standard fire alarm call point
- EMERGENCY SIGNAGE**
- Standard fire alarm pull point
 - Standard fire alarm call point
- ELECTRICAL**
- Fire alarm panel
 - Emergency lighting
- DOOR SYMBOLS**
- 3000 30 minute fire rating fire door
- FIRE PROTECTION EQUIPMENT**
- Fire detector
 - Smoke detector
 - Fire alarm in corridor
 - Fire alarm in wing/riser

REVISION DATE

dignell shacklady ewing
 Architects & Designers
 55 Spencer Street
 Birmingham B3 6DA
 T +44 (0)121 634 1134
 www.dignellshackladyewing.com

RIBA **Chartered Practitioner**

Client: GAIN THRESIDERS
 Job: ECGHANE ROAD
 Drawing Title: PROPOSED LENSING LAYOUT
 Date: 1:30 @AT
 Scale: 3/4
 MAY 2015
 Drawn By: Zoran G.
 2D Checker: Zoran G.
 2014-1575
 Drawing Number: 1476-400
 Status: Issues

Copyright © 2015 Dignell Shacklady Ewing. All rights reserved. This drawing is the property of Dignell Shacklady Ewing and is not to be reproduced, stored in a retrieval system, or transmitted in any form or by any means, electronic, mechanical, photocopying, recording, or by any information storage and retrieval system, without the prior written permission of Dignell Shacklady Ewing. The user of this drawing is deemed to have accepted the terms and conditions of use set out in the 'Terms and Conditions of Use' document located on the company website.

CITY OF WESTMINSTER**MEMORANDUM**

**TO
REFERENCE****Ola Owojori, Licensing Officer
15/04057/LIPN**

FROM**Environmental Health Consultation Team
4th Floor West, City Hall****TELEPHONE****0207 641 3187****BEING DEALT WITH BY
DATE****Nicola Curtis (ncurtis@westminster.gov.uk)
24th June 2015**

Licensing Act 2003**Raging Ball Sports Club, Basement 159-163 Edgware Road, London, W2
2HR**

I refer to the application for a new Premises Licence for the above premises.

The premises are situated in the Edgware Road Stress Area.

The applicant has submitted the following plans for the premises:

- ◆ Proposed Licensing Layout dated May 2015, drawing number 1575-400

This representation is based on the plans and Operating Schedule submitted.

The applicant is seeking the following licensable activities:

1. Regulated Entertainment Monday to Sunday 0000 to 0000 hours comprising
 - a. Indoor Sporting Events
 - b. Playing of Recorded Music 'indoors'
2. The Provision of Late Night Refreshment 'indoors' Monday to Sunday 2300 to 0500 hours
3. The Supply of Alcohol both 'on' and 'off' the premises
 - a. Monday to Sunday 0800 to 0300 hours
 - b. On the day when British Summer Time Commences, and on that day only, licensable activities will be extended by one hour
 - c. From the end of permitted hours on New Year's Eve to the start of permitted hours on New Year's Day

I wish to make the following representations in relation to the above application:

1. The Regulated Entertainment requested and the hours requested for this activity will have the likely effect of causing an increase in Public Nuisance in the Edgware Road Stress Area and may impact upon Public Safety.
2. The provision of Late Night Refreshment 'indoors' and the hours requested for this activity will have the likely effect of causing an increase in Public Nuisance in the Edgware Road Stress Area.
3. The Supply of Alcohol both 'on' and 'off' the premises and the hours requested for this activity will have the likely effect of causing an increase in Public Nuisance in the Edgware Road Stress Area and may impact upon Public Safety.

The applicant has provided additional information within the operating schedule which is being considered but does not fully address the concerns of Environmental Health.

The applicant is advised to contact the undersigned to arrange a suitable time for inspection of the premises.

The granting of the new Premises Licence as presented would have the likely effect of causing an increase in Public Nuisance in the Edgware Road Stress Area and may impact upon Public Safety.

Should you wish to discuss the matter further please do not hesitate to contact me.

Nicola Curtis
Environmental Health Enforcement Officer

CITY OF WESTMINSTER**MEMORANDUM**

**TO
REFERENCE****Ola Owojori, Licensing Officer
15/04057/LIPN**

FROM**Environmental Health Consultation Team
4th Floor West, City Hall****TELEPHONE****0207 641 3187****BEING DEALT WITH BY****Nicola Curtis (ncurtis@westminster.gov.uk)****DATE****22nd July 2015**

**Raging Ball Sports Club, Basement 159-163 Edgware Road, London, W2
2HR**

Proposed Environmental Health Conditions

1. A noise limiter must be fitted to the musical amplification system set at a level determined by and to the satisfaction of an authorised officer of the Environmental Health Service, Premises Management so as to ensure that no noise nuisance is caused to local residents or businesses. The operational panel of the noise limiter shall then be secured by key or password to the satisfaction of officers from the Environmental Health Service and access shall only be by persons authorised by the Premises Licence holder. The limiter shall not be altered without prior agreement with the Environmental Health Service. No alteration or modification to any existing sound system(s) should be effected without prior knowledge of an authorised Officer of the Environmental Health Service. No additional sound generating equipment shall be used on the premises without being routed through the sound limiter device.
2. No noise shall emanate from the premises nor vibration be transmitted through the structure of the premises which gives rise to a nuisance.
3. Loudspeakers shall not be located in the ground floor entrance lobby or outside the premises building.
4. All external doors shall be kept closed after 21:00 hours, or at any time when regulated entertainment takes place, except for the immediate access and egress of persons.
5. Notices shall be prominently displayed at all exits requesting patrons to respect the needs of local residents and businesses and leave the area quietly.

6. Notices shall be prominently displayed at any area used for smoking requesting patrons to respect the needs of local residents and use the area quietly.
7. Patrons permitted to temporarily leave and then re-enter the premises, e.g. to smoke, shall be limited to 15 persons at any one time.
8. Patrons permitted to temporarily leave and then re-enter the premises, e.g. to smoke, shall not be permitted to take drinks or glass containers with them.
9. A direct telephone number for the manager at the premises shall be publicly available at all times the premises is open. This telephone number is to be made available to residents and businesses in the vicinity.
10. No waste or recyclable materials, including bottles, shall be moved, removed from or placed in outside areas between 23.00 hours and 08.00 hours on the following day.
11. No deliveries to the premises shall take place between 23.00 and 08.00 on the following day.
12. There shall be no sales of hot food or hot drink for consumption off the premises
13. The number of persons permitted in the premises at any one time (excluding staff) shall not exceed (X) persons.
14. Substantial food and non-intoxicating beverages, including drinking water, shall be available in all parts of the premises where alcohol is sold or supplied for consumption on the premises.
15. A Challenge 25 proof of age scheme shall be operated at the premises where the only acceptable forms of identification are recognised photographic identification cards, such as a driving licence, passport or proof of age card with the PASS Hologram.
16. The Licence will have no effect until the Licensing Authority are satisfied that the premises is constructed or altered in accordance with the appropriate provisions of the District Surveyor's Association – Technical Standards for Places of Entertainment and the reasonable requirements of Westminster Environmental Health Consultation Team, at which time this condition will be removed from the Licence.
17. Before the premises open to the public, the plans as deposited will be checked by the Environmental Health Consultation Team to ensure they are an accurate reflection of the premises constructed. Where the premises layout has changed during the course of construction a variation application may be required

18. All external emergency exit doors shall be fitted with sensor alarms and visible indicators to alert staff when the doors have been opened.
19. The approved arrangements at the premises, including means of escape provisions, emergency warning equipment, the electrical installation and mechanical equipment, shall at all material times be maintained in good condition and full working order.
20. The means of escape provided for the premises shall be maintained unobstructed, free of trip hazards, be immediately available and clearly identified in accordance with the plans provided.
21. All emergency exit doors shall be available at all material times without the use of a key, code, card or similar means.
22. All emergency doors shall be maintained effectively self-closing and not held open other than by an approved device.
23. The edges of the treads of steps and stairways shall be maintained so as to be conspicuous.
24. Curtains and hangings shall be arranged so as not to obstruct emergency safety signs or emergency equipment.
25. All fabrics, curtains, drapes and similar features including materials used in finishing and furnishing shall be either non-combustible or be durably or inherently flame-retarded fabric. Any fabrics used in escape routes (other than foyers), entertainment areas or function rooms, shall be non-combustible.
26. Appropriate safety devices (such as 30mA Residual Current Devices at Source) must be used for electrical apparatus, particularly for any electrical equipment exposed to adverse conditions or in association with hand held devices (e.g. microphones). The competent person must make a certificate of inspection of the electrical installation available for inspection.
27. Any special effects or mechanical installations shall be arranged and stored so as to minimise any risk to the safety of those using the premises. The following special effects will only be used on 10 days prior notice being given to the Licensing Authority where consent has not previously been given.
 - dry ice and cryogenic fog
 - smoke machines and fog generators
 - pyrotechnics including fireworks
 - firearms
 - lasers
 - explosives and highly flammable substances.

- real flame.
- strobe lighting.

28. No person shall give at the premises any exhibition, demonstration or performance of hypnotism, mesmerism or any similar act or process which produces or is intended to produce in any other person any form of induced sleep or trance in which susceptibility of the mind of that person to suggestion or direction is increased or intended to be increased.

NOTE: (1) This rule does not apply to exhibitions given under the provisions of Section 2(1A) and 5 of the Hypnotism Act 1952.

29. There is to be no external advertisement on the street of bar facilities.

30. The primary use of the premises shall be as a Members Snooker Club.

31. Access to the premises may only be by members of a private club and their bona fide guests (not exceeding 4 guests per member). No person shall be admitted to membership of the private club or be entitled to take advantage of any of the privileges of membership without an interval of at least 48 hours between their nomination or application for membership and their admission.

32. A list of the names and addresses of members of the Club shall be kept on the premises at all times together with a book showing the names and dates of attendance of any guests introduced by members. Both the list and the book shall be produced on demand for inspection by the police or an authorised officer of the Council.

Should you wish to discuss the matter further please do not hesitate to contact me.

Nicola Curtis
Environmental Health Enforcement Officer

Owojori, Olaposi

From: Andrew Woods <andrew@woodswhur.co.uk>
Sent: 12 August 2015 15:57
To: Owojori, Olaposi; Curtis, Nicola; Guerra, Reaz
Cc: Andrew Woods
Subject: RE: Raging Ball - Edgware Rd Alcohol Start

All

I have taken instructions and happy to amend the start time for alcohol to core hours for alcohol 10am Monday to Saturday and Midday on Sundays.

Hope that's ok.

Andy

Andrew Woods

Woods Whur 2014 Ltd
Tel: +44 (0)113 234 3055
Mobile: 07738 170138

andrew@woodswhur.co.uk

Devonshire House, 38 York Place, Leeds LS1 2ED.

From: Owojori, Olaposi [<mailto:owojori@westminster.gov.uk>]
Sent: 12 August 2015 15:46
To: Andrew Woods; Curtis, Nicola; Guerra, Reaz
Subject: RE: Raging Ball - Edgware Rd Proposed EH Conditions

Do you still want alcohol to begin at 08:00 or you're also proposing core hours

Regards

Mr Ola Owojori
Senior Licensing Officer
Licensing Team
Public Protection and Licensing Department
Westminster City Council
4th Floor East
64 Victoria Street
London SW1E 6QP

Telephone 020 7641 7830
Fax 020 7641 7815
email: owojori@westminster.gov.uk
Web: www.westminster.gov.uk



USE PUBLIC ACCESS FOR
INFORMATION ON APPLICATIONS,
TO CHECK THEIR PROGRESS OR STATUS

PUBLIC  ACCESS

Register to receive email alerts on properties or
streets you are interested in?



You can now apply online for the majority of licensing regimes that the authority is responsible for. Please visit www.westminster.gov.uk/licensing and following the relevant links to apply.

 please don't print this e-mail unless you really need to

From: Andrew Woods [<mailto:andrew@woodswhur.co.uk>]
Sent: 12 August 2015 15:08
To: Owojori, Olaposi; Curtis, Nicola; Guerra, Reaz
Cc: Andrew Woods
Subject: RE: Raging Ball - Edgware Rd Proposed EH Conditions

Hi Ola

I can confirm that the start time in respect of the below will be 9am as per core hours.

Regards
Andy

Andrew Woods

Woods Whur 2014 Ltd
Tel: +44 (0)113 234 3055
Mobile: 07738 170138

andrew@woodswhur.co.uk

Devonshire House, 38 York Place, Leeds LS1 2ED.

From: Owojori, Olaposi [<mailto:owojori@westminster.gov.uk>]
Sent: 12 August 2015 14:09
To: Andrew Woods; Curtis, Nicola; Guerra, Reaz
Subject: RE: Raging Ball - Edgware Rd Proposed EH Conditions

Hi Andrew,

Following the reduction of terminal hours, please confirm when indoor Sporting Event and Recorded Music will commence.

Regards

Mr Ola Owojori
Senior Licensing Officer
Licensing Team
Public Protection and Licensing Department
Westminster City Council
4th Floor East

64 Victoria Street
London SW1E 6QP

Telephone 020 7641 7830
Fax 020 7641 7815
email: owojori@westminster.gov.uk
Web: www.westminster.gov.uk



USE PUBLIC ACCESS FOR
INFORMATION ON APPLICATIONS,
TO CHECK THEIR PROGRESS OR STATUS

PUBLIC  ACCESS

Register to receive email alerts on properties or
streets you are interested in?



You can now apply online for the majority of licensing regimes that the authority is responsible for. Please visit www.westminster.gov.uk/licensing and following the relevant links to apply.

 please don't print this e-mail unless you really need to

From: Andrew Woods [<mailto:andrew@woodswhur.co.uk>]
Sent: 11 August 2015 09:30
To: Curtis, Nicola; Owojori, Olaposi; Guerra, Reaz
Cc: Andrew Woods
Subject: RE: Raging Ball - Edgware Rd Proposed EH Conditions

Nicola

Thanks for the e mail below which I have discussed with my client. Would you kindly note the following;

1. We are happy to reduce the hours sought for licensable activities to Midnight Sunday to Thursday and 1am Friday and Saturday.
2. We are happy to agree your proposed condition 1 to install a Noise Limiter for any amplified music. As a general rule there will only be background music through a Juke Box/in house system but we are happy for a limiter to be installed so we agree this condition.
3. We understand that Building Regs will state a maximum of 150 but we are proposing to have 14 tables for pool/snooker and therefore in reality we would be looking at 100. I am happy to agree 100?
4. Happy with the amended condition 30.
5. Club Rules

Club rules are printed on each and every membership application form that is completed and signed by anyone applying for membership. Any member not observing the rules will be expelled from the club. Applicants must provide the following information on production of 2 forms of id, one must show a photo and both must show name and address. We generally request a for driving licence or photo id and a recent utility bill. Title, First Name, Surname, Date of Birth, Mobile tel, Home tel, email address, full address with postcode, declaration that the above info is correct, signed & dated on the form.

The above information is entered onto computerised membership system and a photograph is taken of the applicant that is also held on the same system. The original application form is filed and held on site for inspection at any time by any of the responsible authorities.

CLUB RULES

1. NAME – The name of the club is The Raging Ball.

2. OBJECTIVES OF THE CLUB – (a) The provision of opportunities for playing Snooker, Billiards, Pool and other recreational activities including chess, dominoes, darts, cribbage. (b) The ancillary provision of a licensed bar and light refreshments for members. (c) To provide competitions and coaching at all levels for members. (d) To provide fundraising events and a meeting place for club members. (e) The provision and maintenance of a club house at lower ground floor, 159-163 Edgware Road, London, W2 2HR.
3. CATEGORIES OF MEMBERSHIP – Full, Corporate, Student, Junior & Senior.
4. ADMISSION OF MEMBERS – Candidates for membership must complete an application form, having read and understood the club rules, provided the required identification and had their photo taken.
5. ELECTION TO MEMBERSHIP – (a) All applications for membership shall be in writing on the form to be provided by the proprietors and completed and signed by the candidate. (b) The election of candidates after nomination in accordance with this rule shall be notified whether his or her application has been accepted or rejected. (c) If accepted, the candidate shall immediately pay any subscription due and shall be issued with a membership card.
6. ANNUAL SUBSCRIPTIONS – Each member shall pay an annual subscription in advance at a rate to be decided from time to time by the management.
7. MEMBERSHIP CARDS – Members shall produce their membership cards at the beginning of each visit to the club. In the event of a member losing a membership card, a replacement will be provided by the club at the member's expense.
8. REGISTER OF MEMBERS – The name and address of every member shall be maintained in a register of members kept in the club for that purpose.
9. NO ALCOHOL IS PERMITTED OFF THE CLUB PREMISES.
10. NO SMOKING IS PERMITTED ON THE CLUB PREMISES.
11. EXPULSION OF MEMBERS – The management of the club shall have the power to expel summarily any member who fails to observe the rules of the club or whose conduct in it's opinion renders him or her unfit for membership of the club. No reason for expulsion needs to be given.
12. GUESTS – Any member shall be entitled to introduce a maximum of four (4) guests to the club in any one day, provided that no person whose application for membership has been declined or who has been expelled from the club shall be introduced as a guest. Members are held fully responsible for their guests good conduct at all times whilst entering, remaining on and exiting the club premises.
13. FOOD AND DRINKS – No food or drinks purchased outside of the club are to be consumed on club premises.
14. HOURS OF OPENING AND CLOSING – The club premises shall be open to it's members during such hours as may be determined from time to time by the proprietors (within the consent of the local authority).
15. DAMAGE – Any damage to club property or equipment must be paid for by the person(s) responsible.
16. NEIGHBOURS – Members must mak every effort to ensure they do not disturb neighbours when entering or leaving the club premises.
17. DRESS – No member or guest shall be admitted into the club whose dress shall be considered objectionable or prejudicial to the interest of the club.
18. RISK – Members and guests using club premises and all means of access thereto do so at their own risk and take the premises as they find them absolving the club and it's proprietors from all liability for any accident, loss, injury or damage to a member or their property.

The above are the standard club rules that we have operated in our existing clubs for many years now.

Summary

- We have agreed the Noise Limiter conditions
- We have reduced hours for licensable activities
- We have proposed a 100 capacity figure
- We have agreed condition 30
- We have provided rules.
- We have also proposed the additional condition ' The Front door to the premises will be locked at all times with access to the Premises only permitted to members and their guests who will be allowed access via an intercom system.

I am keen to try and get a typed up version of any agreed conditions prepared this week and wonder if at all possible if you would confirm whether you are happy with everything we have agreed and whether your rep can be withdrawn?

Regards
Andy

Andrew Woods

Woods Whur 2014 Ltd
Tel: +44 (0)113 234 3055
Mobile: 07738 170138

andrew@woodswhur.co.uk

Devonshire House, 38 York Place, Leeds LS1 2ED.

From: Curtis, Nicola [<mailto:ncurtis@westminster.gov.uk>]
Sent: 6 August 2015 09:17
To: Andrew Woods; Owojori, Olaposi; Guerra, Reaz
Subject: RE: Raging Ball - Edgware Rd Proposed EH Conditions

Hi Andy,

Thank you for the information below.

1. Please can you clarify exactly what days, hours and activities are now being sought? Please also confirm the withdrawal of off-sales.
2. Regarding my proposed condition 1, would you be willing to withdraw recorded music from the application if all you are after is background music? If so then I will no longer require the condition.
3. For proposed condition 13, what kind of capacity figure would your client be looking for?
4. With regards to condition 30 I have made an error. My proposed wording should read "The licensable activities authorised by this licence and provided at the premises shall be ancillary to the main function of the premises as a members' snooker and sports club".
5. For conditions 31 and 32 – Would you be able to forward me the rules of membership and code of conduct/disciplinary code for members and guests?

Many thanks
Nicola

From: Andrew Woods [<mailto:andrew@woodswhur.co.uk>]
Sent: 03 August 2015 17:54
To: Curtis, Nicola; Owojori, Olaposi; Andrew Woods
Subject: FW: Raging Ball - Edgware Rd Proposed EH Conditions

Hi Nicola

As you will have seen from my e mail to Reaz I have now met with the applicant Mr Tresidder.

I have proposed a further condition to Reaz

'The Front door to the premises will be locked at all times with access to the Premises only permitted to members and their guests who will be allowed access via an intercom system'.

With regard to your proposed 31 conditions we agree to most of them but please see below.

Condition 1 – We do not propose having anything other than background music and wouldn't want to have a noise limiter for that. Are we ok that such music doesn't fall under 'musical amplification' as set out in condition 1 ?

2- 12 agreed

13 – happy to agree a figure with you

15-29 agreed

30 – Happy with this but we are likely to apply for a Bingo Premises Licence for the members club so I wonder if it best worded 'Members Snooker and Sports Club'

31 – We would not want a 48 hour 'cooling off period'. This was a requirement under The Gaming Act 1968 for all Gaming Premises including members clubs which had the benefit of certain Gaming Machines. It is not a requirement for any Casino/Bingo club under the 2005 Act and we do have the 2 door entry system as well.

Can you confirm Condition 1 and let me know if you are happy with the 48 hour bit coming out of 31 and then we are ok with everything.

Look forward to hearing from you – happy to meet up if required.

Andy

Andrew Woods

Woods Whur 2014 Ltd
Tel: +44 (0)113 234 3055
Mobile: 07738 170138

andrew@woodswhur.co.uk

Devonshire House, 38 York Place, Leeds LS1 2ED.

From: Curtis, Nicola [<mailto:ncurtis@westminster.gov.uk>]
Sent: 22 July 2015 14:04
To: Andrew Woods; Guerra, Reaz
Cc: Carole Collingwood; Owojori, Olaposi
Subject: Raging Ball - Edgware Rd Proposed EH Conditions

Dear Andy,

Please find attached my proposed conditions for this application. Please confirm that your client has withdrawn off-sales as per your below email.

I am now on annual leave until the 5th August so will be happy to discuss this case upon my return.

Many thanks
Nicola

From: andrew@woodswhur.co.uk [<mailto:andrew@woodswhur.co.uk>]
Sent: 22 July 2015 12:09
To: Curtis, Nicola; Guerra, Reaz; Andrew Woods
Cc: Carole Collingwood
Subject: Re: Raging Ball - Edgware Rd.

Hi Nicola

My client would like 1am but if you would like do suggest 11.30pm then please do. This applies to all the below - please suggest your proposals.

Regards
Andy
Sent from my BlackBerry® smartphone on O2

From: "Curtis, Nicola" <ncurtis@westminster.gov.uk>
Date: Wed, 22 Jul 2015 11:12:31 +0100
To: Andrew Woods<andrew@woodswhur.co.uk>; Guerra, Reaz<rguerra@westminster.gov.uk>
Cc: Carole Collingwood<carole@woodswhur.co.uk>
Subject: RE: Raging Ball - Edgware Rd.

Hi Andy,

I'm just reviewing the below. Please can you clarify regarding your point 6 – is the terminal hour for Thursday nights to be 2330 or 0100?

Many thanks
Nicola

From: Andrew Woods [<mailto:andrew@woodswhur.co.uk>]
Sent: 25 June 2015 13:13
To: Curtis, Nicola; Guerra, Reaz
Cc: Carole Collingwood; Andrew Woods
Subject: Raging Ball - Edgware Rd.

Dear Reaz/Nicola

As you are both aware I am instructed by Gavin Tresidder who is the Director of Future Leisure Limited who have applied for the Premises Licence for the Raging Ball at 159-163 Edgware Road, London.

I have received both of your representations against the application and met briefly with Reaz yesterday to explain the application further and to see if I could propose any conditions/amendments to the application which would allow you to withdraw your representation given the very specific nature of the proposed premises.

The proposed premises are set in the basement of 159-163 Edgware Road and will operate as a Snooker Club for members in a similar way to the Rileys premises of Victoria. I should stress at this stage that the premises will not be similar to Rileys on Haymarket which do not operate as a traditional Snooker Club. Gavin Tresidder currently operates three other similar premises in St Albans, High Wycombe and Greenford and has been in the leisure industry for over 20 years operating amongst other things Bingo Clubs, Adult Gaming Centres and Snooker Clubs. The three premises currently operated by Mr Tresidder all have the benefit of Bingo Premises Licences and Gavin Tresidder's company have Operating Licences issued by the Gambling Commission for Bingo and Adult Gaming Centres as well as the supply and installation of Gaming Machines. Mr Tresidder would welcome the opportunity of meeting with you at some stage should you have any queries or wish to see the proposed premises although the premises are currently being worked on and will ultimately be handed over to Mr Tresidder (subject to any licence being granted) as a shell for Mr Tresidder to fit out. Mr Tresidder is proposing to take a lease of the premises subject to a Premises Licence being granted.

Whilst we appreciate that the premises in St Albans, Greenford and High Wycombe may be too far for you to carry out a visit Mr Tresidder's cousin operates similar premises close to Kings Cross although it is fair to say that the premises in Kings Cross whilst operating in a similar way are not finished to the same standard that the proposed premises at 159-163 Edgware Road will be finished. Should you wish to perhaps meet Mr Tresidder and I to discuss the conditions which I am about to propose then perhaps we could meet at the club in Kings Cross so that you can have a look at the premises.

I have explained to Mr Tresidder the comments made by Reaz and as a result of our meeting we would propose the following conditions. I can agree the exact wording of these conditions in due course should the conditions be acceptable.

1. There shall be no off sales.
2. Access to the premises will only be permitted at all times to members and membership can only be obtained upon production of photographic identification. (Currently the proposed membership requirement in the application is after core hours).
3. Entry to the premises will be via a buzzer/locked door. In practice the front door to the premises will be closed and locked. Any person wishing to gain entry to the club will press a buzzer. Staff in the club will be able to both see the person wishing to get into the club and ask for confirmation that the person is a member and will then buzz to allow that person entry to the premises.
4. No under 18's permitted on the premises after 9.00pm.
5. CCTV will be throughout the premises and to the satisfaction of the Police.
6. We are open to discussing operating hours should you feel that the above conditions are satisfactory and would certainly agree to reduce the hours proposed for the sale of alcohol to 1.00am Thursday, Friday and Saturday and 11.30 pm Sunday to Thursday. It is not proposed to apply for any other licensable activities other than indoor sports (should there ever be a competition at the premises) and late night refreshment.
7. The Premises will operate as a Members Snooker Club.

I wonder if you would look at the above proposals and let me know whether they are acceptable and/or whether you have any other requirements. The proposal will be to apply for a Bingo Premises Licence under the Gambling Act 2005 in due course but this application will not be submitted until any Premises Licence is granted under the Licensing Act 2003 and Mr Tresidder has carried out his works at the premises.

I am away until 8 July 2015 but having acted for Mr Tresidder in other applications will happily pick up emails and deal with this whilst I am away and it would be good if at some stage you could meet Mr Tresidder when you have considered the proposed conditions.

Kind regards.

Andy

Andrew Woods

Woods Whur 2014 Ltd
Tel: +44 (0)113 234 3055
Mobile: 07738 170138

andrew@woodswhur.co.uk

Devonshire House, 38 York Place, Leeds LS1 2ED.

This email, including any attachments, is confidential and may be legally privileged. If it is received by mistake please let us know and delete from your system - do not read or copy it or disclose its contents to anyone. Any liability (in negligence or otherwise) arising from any third party relying on this email is excluded. Emails are not secure and cannot be guaranteed to be free of errors or viruses. It is your responsibility to scan emails and attachments for viruses before opening them. No responsibility is accepted for emails unconnected with our business. Messages may be monitored for compliance purposes and to protect our business.

The principal office of Woods Whur 2014 Limited is at Devonshire House, 38 York Place, Leeds LS1 2ED. VAT number 187289453: info@woodswhur.co.uk

Woods Whur 2014 Limited is authorised and regulated by the Solicitors Regulation Authority (the SRA), details of which can be accessed on the SRA website (<http://www.sra.org.uk/solicitors/code-of-conduct.page>) . SRA number: 613288.

Find hundreds of free and low-cost summer activities for your family with Summer in the City. Visit <http://www.mysummerinthecity.org.uk>

Owojori, Olaposi

From: Guerra, Reaz
Sent: 23 June 2015 11:18
To: Carole Collingwood
Cc: Premises Licensing; Owojori, Olaposi
Subject: 15/040570/LIPN - Raging Bull Sports Club, 159 -163 Edgware Road W2 2HR

Dear Carole,

Application for a New Premises Licence – 15/040570/LIPN

Raging Bull Sports Club, 159 -163 Edgware Road W2 2HR

With reference to the above application, I am writing to inform you that the Metropolitan Police, as a Responsible Authority, will be objecting to this application as it is our belief that if granted the application would undermine the Licensing Objectives.

The venue is situated in the Edgware Road Stress Area, a locality where there is traditionally high crime and disorder. We have concerns that this application will cause further policing problems in an already demanding area.

An officer from this unit will be in contact with you shortly to discuss the application. However it is for the applicant to prove that this application will not add to the cumulative impact problems already experienced in this area.

It is for these reasons that we are objecting to the application.

Should you wish to discuss the matter further please contact PC Reaz Guerra on **0207 641 1709** or via email, rguerra@westminster.gov.uk.

Yours Faithfully,

Reaz Guerra PC1614CW

Westminster Police Licensing Team

PC Reaz Guerra 1614CW

Westminster Police Licensing Team
Westminster City Hall
4th Floor, 64 Victoria Street
London SW1E 6QP
Tel - 0207 641 1708

Police Proposed Provisional Conditions

Raging Bull Sports Club,

Basement 159 – 163 Edgware Road, London W2 2HR

Application amended to On Sales only.

The premises shall install and maintain a comprehensive CCTV system as per the minimum requirements of the Westminster Police Licensing Team. All entry and exit points will be covered enabling frontal identification of every person entering in any light condition. The CCTV system shall continually record whilst the premises is open for licensable activities and during all times when customers remain on the premises. All recordings shall be stored for a minimum period of 31 days with date and time stamping. Viewing of recordings shall be made available immediately upon the request of Police or authorised officer throughout the preceding 31 day period.

A staff member from the premises who is conversant with the operation of the CCTV system shall be on the premises at all times when the premises is open. This staff member must be able to provide a Police or authorised council officer copies of recent CCTV images or data with the absolute minimum of delay when requested.

A minimum of (No. TBC) SIA licensed door supervisors shall be on duty at the premises at all times whilst it is open for business.

At least (No. TBC) SIA licensed door supervisors shall be on duty at the entrance of the premises at all times whilst it is open for business.

There shall be no sales of alcohol for consumption off the premises.

Patrons permitted to temporarily leave and then re-enter the premises, e.g. to smoke, shall be limited to (no. TBC) persons at any one time.

The licence holder shall ensure that any queue to enter the premises which forms outside the premises is orderly and supervised by door staff so as to ensure that there is no public nuisance or obstruction to the public highway.

Substantial food and non-intoxicating beverages, including drinking water, shall be available in all parts of the premises where alcohol is sold or supplied for consumption on the premises.

There shall be no striptease or nudity, and all persons shall be decently attired at all times, except when the premises are operating under the authority of a Sexual Entertainment Venue licence.

No advertisements of any kind (including placard, poster, sticker, flyer, picture, letter, sign or other mark) that advertises or promotes the establishment, its premises, or any of its events,

facilities, goods or services shall be inscribed or affixed upon the surface of the highway, or upon any building, structure, works, street furniture, tree, or any other property, or be distributed

A Challenge 25 proof of age scheme shall be operated at the premises where the only acceptable forms of identification are recognised photographic identification cards, such as a driving licence, passport or proof of age card with the PASS Hologram

An incident log shall be kept at the premises, and made available on request to an authorised officer of the City Council or the Police, which will record the following:

- (a) all crimes reported to the venue
- (b) all ejections of patrons
- (c) any complaints received concerning crime and disorder
- (d) any incidents of disorder
- (e) all seizures of drugs or offensive weapons
- (f) any faults in the CCTV system or searching equipment or scanning equipment
- (g) any refusal of the sale of alcohol
- (h) any visit by a relevant authority or emergency service.

Patrons permitted to temporarily leave and then re-enter the premises, eg to smoke, shall not be permitted to take drinks or glass containers with them.

The licence holder shall enter into an agreement with a hackney carriage and/or private carriage firm to provide transport for customers, with contact numbers made readily available to customers who will be encouraged to use such services.

A legible register of the full names and address of the members of the club shall be kept on the premises at all times, together with a legible record showing the full names and dates of attendance of any guests introduced by members. Both the list and the book shall be produced on demand for inspection by the Police or an authorised officer of the Council.

Owojori, Olaposi

From: Andrew Woods <andrew@woodswhur.co.uk>
Sent: 03 August 2015 17:10
To: Owojori, Olaposi; Guerra, Reaz; Curtis, Nicola; Andrew Woods
Subject: FW: Raging Ball - Edgware Rd Proposed Police Conditions
Attachments: raging Bull - Conditions.docx

Hi Reaz

Thanks for the above which I have now discussed with the applicant Gavin Tresidder.

The Premises will operate with a 2 door Air Lock system. This means that the front door will be locked and as with members clubs access can only be obtained by pressing a buzzer , staff inside the venue will check that you are a member and you will then be let in. You will walk down the stairs and there will be a second locked door for you to be ' buzzed in'.

As such there is no need for any door staff at the premises – the other members clubs we operate don't use door staff.

We are agreeable to all conditions with the exception of the 2 Door Staff ones and wonder if those 2 could be replaced with the following;

' The Front door to the premises will be locked at all times with access to the Premises only permitted to members and their guests who will be allowed access via an intercom system'.

Happy to meet up and talk through if there is any issue. Can you let me know if the above is OK?

Andy

Andrew Woods

Woods Whur 2014 Ltd
Tel: +44 (0)113 234 3055
Mobile: 07738 170138

andrew@woodswhur.co.uk

Devonshire House, 38 York Place, Leeds LS1 2ED.

From: Guerra, Reaz [<mailto:rguerra@westminster.gov.uk>]
Sent: 23 July 2015 09:20
To: Andrew Woods
Cc: Owojori, Olaposi; Curtis, Nicola
Subject: RE: Raging Ball - Edgware Rd Proposed EH Conditions

Hello Andy,

Please find attached conditions, please call should you wish to discuss.

Thanks
Reaz

Details of public representations relating to 15/04057/LIPN

Comments received electronically via PublicAccess:

- **Mrs Joan Ashbourne - 136 The water Gardens, Burwood Place, London**
Received: 9 Jun 2015
OBJECTION

6:23 PM on 08 Jun 2015

Sir/Madam,

I'm not sure an all-night "sporting club" and alcohol vendor in the basement of the Water Gardens will add much to the quality of life to those of us who live in the Water Gardens--and have for the past 46 years. And raised our children here.

Within 200 yards of the proposed "sporting club" there are eight pubs, bars, coffee shops and alcohol vendors, several open all night, who have not notably contributed to the safety and well-being of local residents. Not to mention that a primary school (the Minerva Academy) is currently above the proposed "club" and has an entrance next to it.

The briefest of visits or calls to the Paddington Green police station, three blocks north of the proposed venue, will confirm my assertions. The very last thing this section of Edgware Road needs is an all-night pool and snooker club selling alcohol "on and off the premises"

Can I ask you--with the greatest respect-- to review and REJECT this and any future applications for the sake of the neighbourhood, residents and the school children.

*PS Would you like an all-night drinking and sporting club under your home?
Exactly!*

- **Mr Kenneth Duncan - No 111 The Water Gardens, Burwood Place, London**
Received:
OBJECTION

11:15 AM on 11 Jun 2015 I am objecting as have concerns around noise and other disturbance. The site is in the basement of the Water Gardens complex which includes many residential flats. Noise tend to reverberate throughout the complex and given the proposal to include music, combined with a (potentially) 24 hour license means that private residents could easily be disturbed by noise leakage (particularly low frequency bass). We already have to put up with

enough disturbance from noisy drinkers, boy racers and the like! Can the applicant or Westminster GUARANTEE silent nights?

- **Ms Susan Woeckel - 366 The water Gardens, London, W2 2DJ**
Received: 24 Jun 2015
OBJECTION

10:41 PM on 24 Jun 2015 The proposed Raging Bull Sports Club site is beneath a major residential development. The club activity will result in late night departures, which in turn will result in noise as people leave the venue. The late night noise levels are already a problem as are the rubbish on the streets, broken glass and vomit from current late night revellers who drink to excess. Any activity which will increase these negative aspects is not desirable. The area in general suffers tremendously from noise pollution from sirens 24/7 and no activity which would result in behaviour requiring the police to attend the Water Gardens should be allowed. It is also doubtful that soundproofing would be sufficient to prevent vibration noise which would impact the Water Garden residents who live directly above the premises. These comments are submitted in relation to Prevention of Crime and Disorder and Prevention of Public Nuisance.

Comments received via other means:

- **Fatiha Hanine - 140 Water Gardens, Burwood Place, London**
Received: by Members of the Public

PREMISES MANAGEMENT
LICENSING SERVICE
15 JUN 2015
CITY OF WESTMINSTER

Licensing Service
Westminster City Hall
64 Victoria Street
London
SW1E 6QP

11th June 2015

Dear Sirs,

RE: NEW PREMISES LICENSE REFERENCE: 15/04057/LIPN

I write in connection with the new premises license mentioned above.

I am the tenant of 140 Water Gardens, Burwood Place, London, W2 2DE I would like to object the new license as I believe this relates to Public Nuisance and I would like to prevent this in my local area and surroundings.

Yours sincerely,

Fatiha Hanine

GPS: 51.5173,-0.1670



12/06/2015 21:48:44

StampThePhoto from ArvanSoft